

# **How To Add Your Uteach Website To Google Search Console**

**Uteach**

# #1 Enter Google Search Console and Start With It

Search "Google Search Console" and continue with Google Search Console Tools

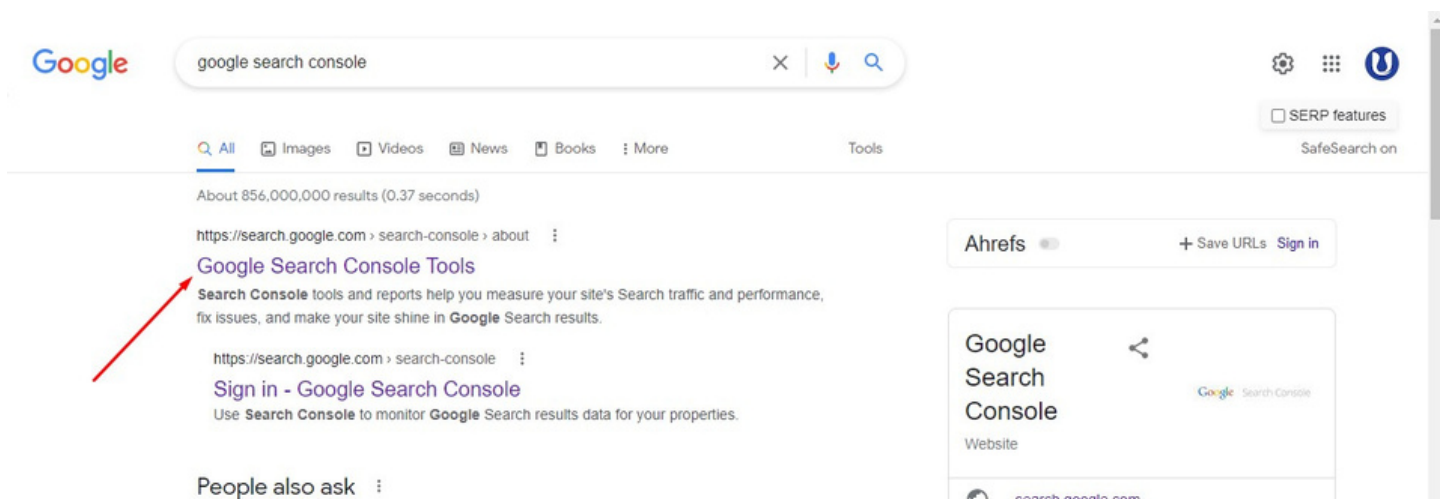

Click on "Start now"

Improve your performance on Google Search

Search Console tools and reports help you measure your site's Search traffic and performance, fix issues, and make your site shine in Google Search results

Start now

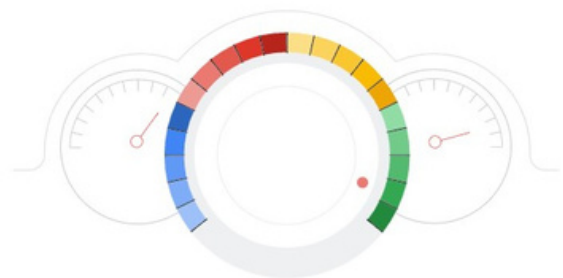

# #2 Add Your Website To Search Console Using HTML Tag

Copy the URL with https:// and paste it in the URL-prefix section. Then click on "Verify"

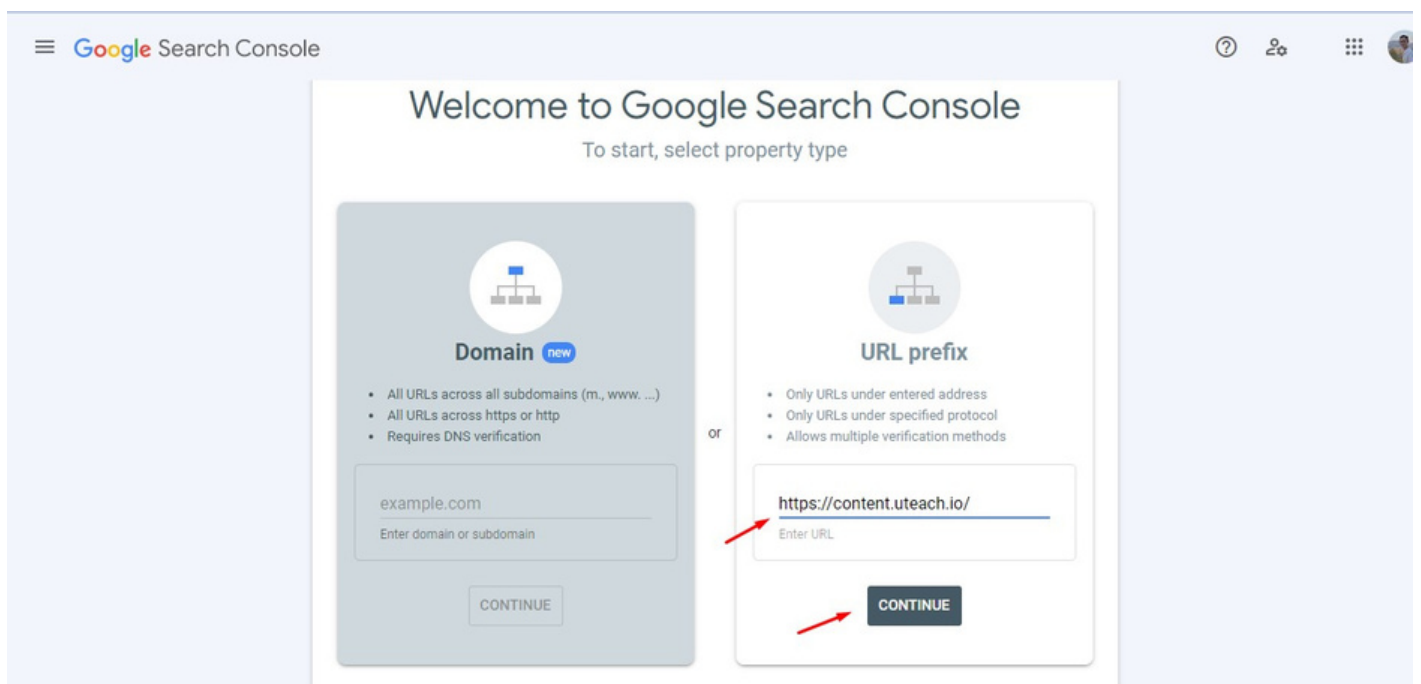

# Copy the HTML Tag

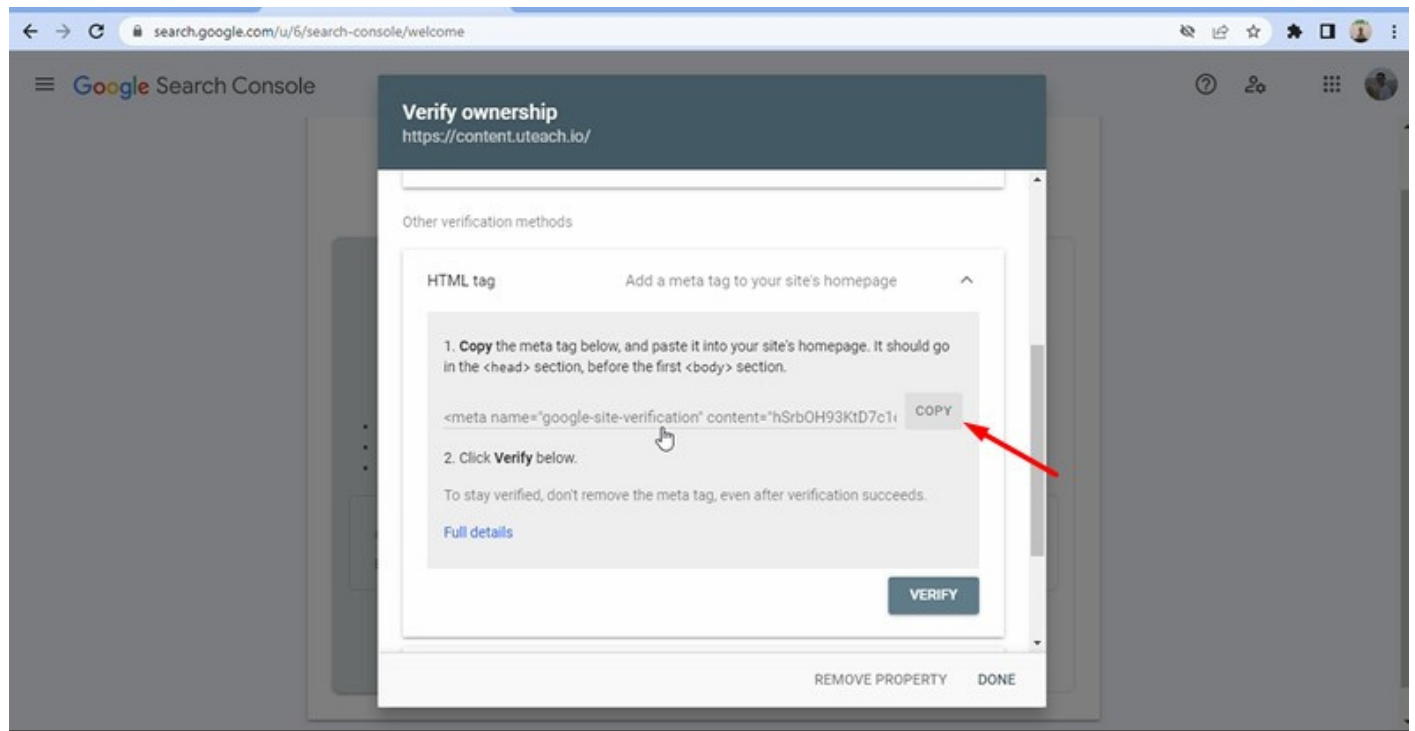

Choose Integrations from Settings.

In the Header scripts write "<script></script>" and paste the code. Click on Save changes

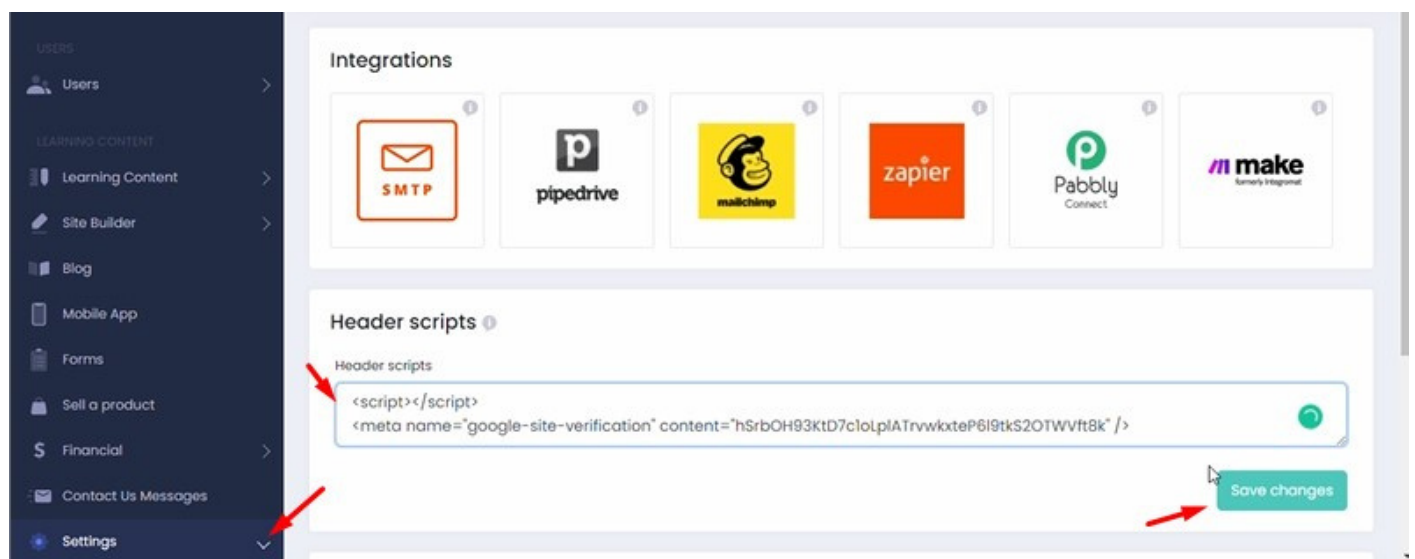

# Click on Verify in Search Console

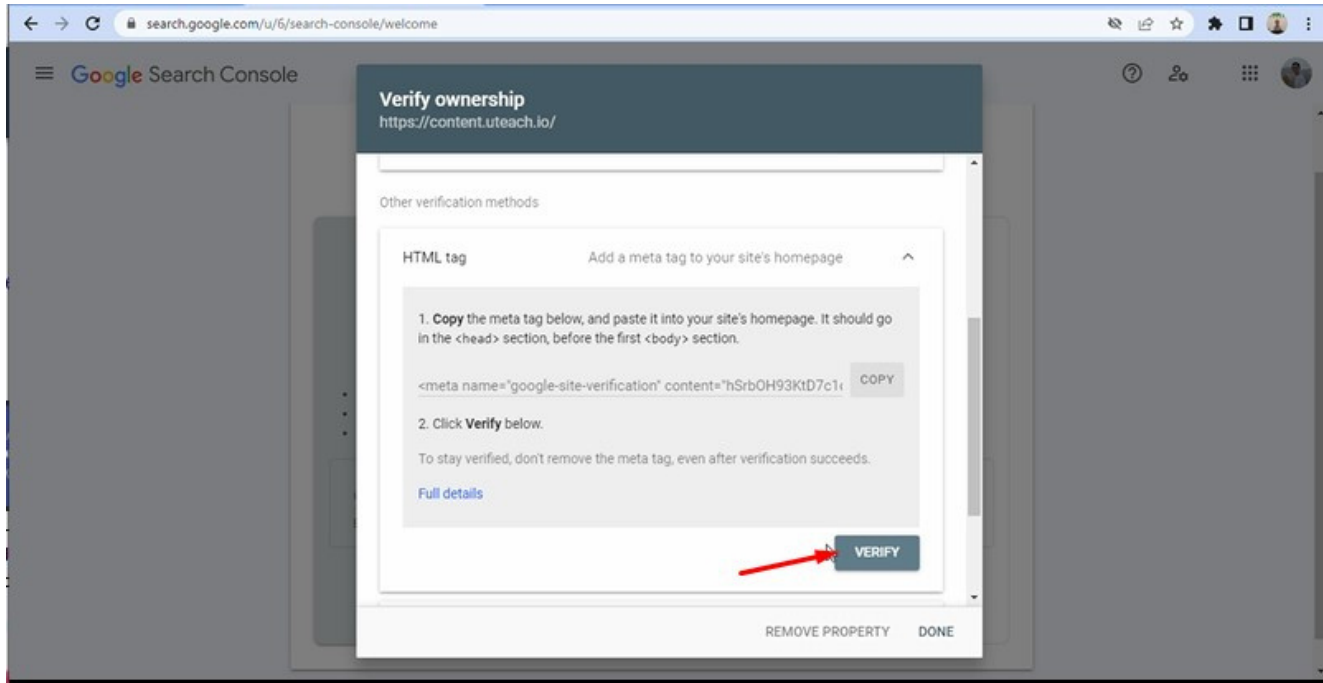

Go to property and explore Google Search Console.

# #2 Add Sitemap

Go to Sitemaps. Write "sitemap.xml/". Then click on "Submit". Your sitemap will be added. If the message be couldn't fetch, waitfor a while and restart or add again.

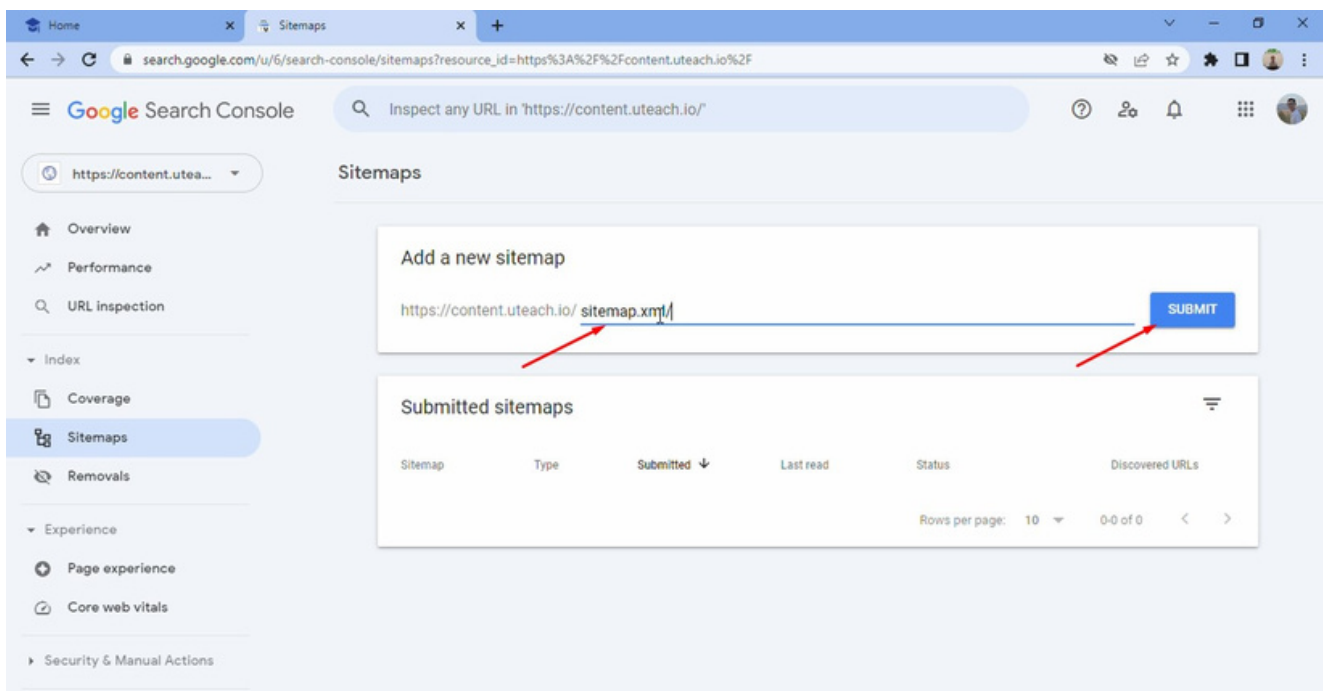

The screenshot shows the Google Search Console interface for the Sitemaps section. The URL in the address bar is `search.google.com/u/6/search-console/sitemaps?resource_id=https%3A%2F%2Fcontent.uteach.io%2F`. The left sidebar shows the navigation menu with 'Sitemaps' selected. The main content area is titled 'Sitemaps' and contains a form to 'Add a new sitemap'. The form has a text input field containing `https://content.uteach.io/sitemap.xml/` and a blue 'SUBMIT' button. Below the form is a table titled 'Submitted sitemaps' with columns for Sitemap, Type, Submitted, Last read, Status, and Discovered URLs. The table is currently empty, and the status is '0-0 of 0'. The 'Rows per page' is set to 10.

# Create and Sell Online Courses With Uteach

*For more guides visit our  
blog: [uteach.io/articles](https://uteach.io/articles)  
YouTube: [Uteach](https://www.youtube.com/uteach)*